

INSTALLATION INSTRUCTIONS

Clump Buster Installation

The Clump Buster breaks up and keeps large clumps of grain out of auger system.

Use the following instructions to install the Clump Buster.

MODELS:

8" U Trough Powersweeps

802-19-1102U, 802-21-1102U, 802-24-1102U, 802-27-1102U,
802-30-1102U, 802-33-1102U, 802-36-1102U, 802-42-1102U,
802-48-1102U

10" U Trough Powersweeps

102-19-1102U, 102-21-1102U, 102-24-1102U, 102-27-1102U,
102-30-1102U, 102-33-1102U, 102-36-1103U, 102-42-1104U,
102-48-1104U, 102-54-1104U, 102-60-1105U

Estimated Completion Time: 30 Min's.

REQUIRED TOOLS / SUPPLIES:

- | | |
|------------------------|------------------|
| (1) Alignment Punch | (1) 9/16" Socket |
| (1) 3/8" Impact Wrench | |

⚠ DANGER

ROTATING AUGER HAZARD KEEP AWAY

To prevent serious injury or death from rotating augers:

1. Do not enter bin unless power is locked out.
2. Turn machine OFF, shut down and lock out power source, unplug power cord and wait for all moving parts to stop before inspecting, servicing or repairing machine.
3. Keep body, hair, and clothing away from moving parts.
4. Stay away from rotating augers. Keep others away.

**FAILURE TO HEED THIS WARNING MAY CAUSE
SERIOUS INJURY OR DEATH.**

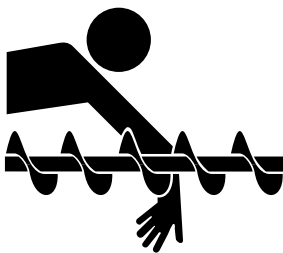

⚠ DANGER

NEVER ENTER BIN UNLESS ALL POWER IS LOCKED OUT AND ANOTHER PERSON IS PRESENT.

Exposed auger and moving parts can cause severe injury or death. Rotating augers are dangerous! Flowing grain may trap and suffocate.

FAILURE TO HEED THIS WARNING MAY CAUSE SERIOUS INJURY OR DEATH.



1. Remove the (Qty. 4) "3/8-16 Bolts" (39), and "3/8" Split Lock Washers" (40).

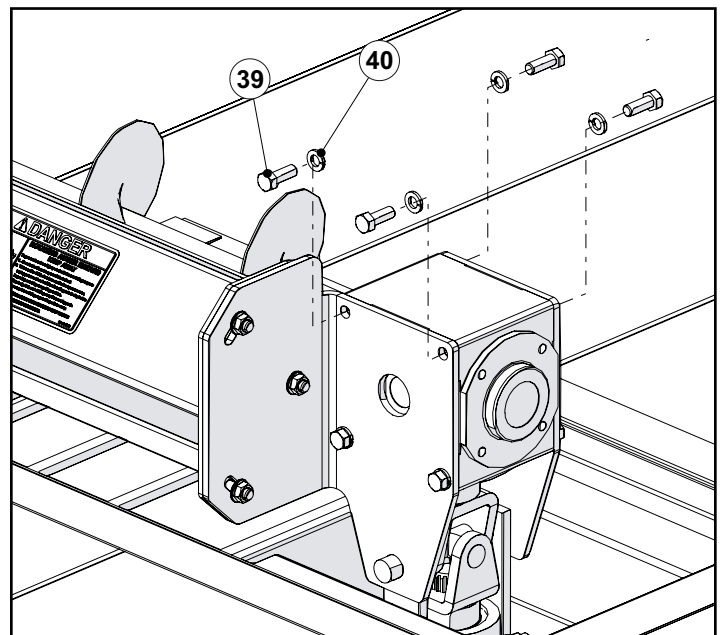

Fig. # 3-1 Clump Buster Installation

2. Orientate the “Clump Buster” ④① as shown below.

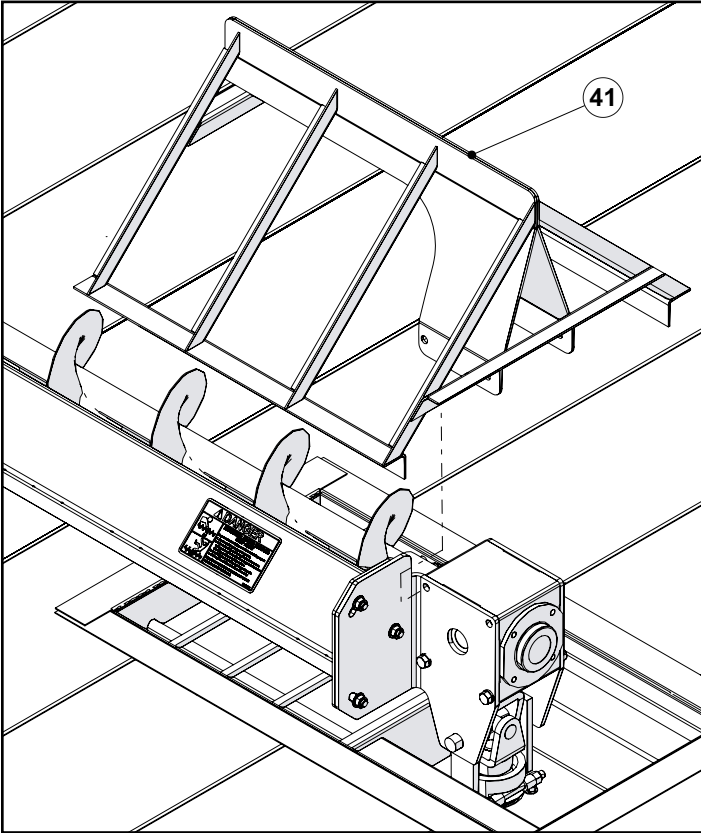

Fig. # 3-2 Clump Buster Installation

3. Assemble the “Clump Buster” ④① to the Power Sweep gearbox using the (Qty. 4) “3/8-16X1 Bolts” ③⑨, and “3/8” Split Lock Washers” ④⑦.

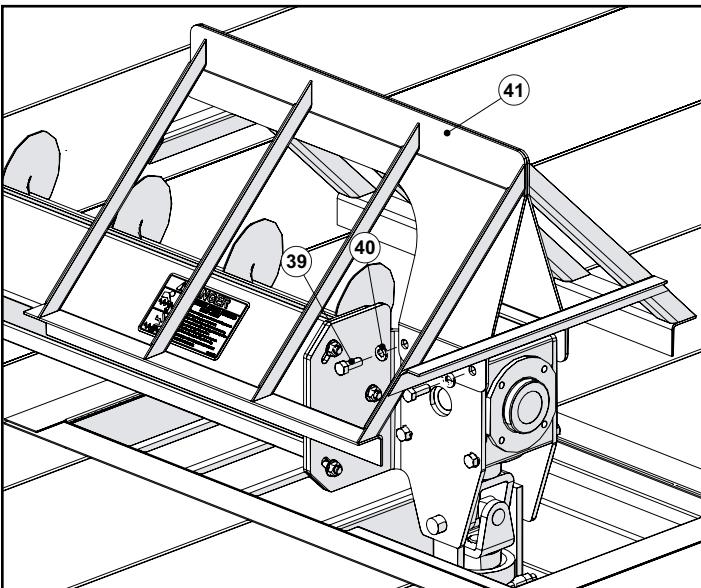
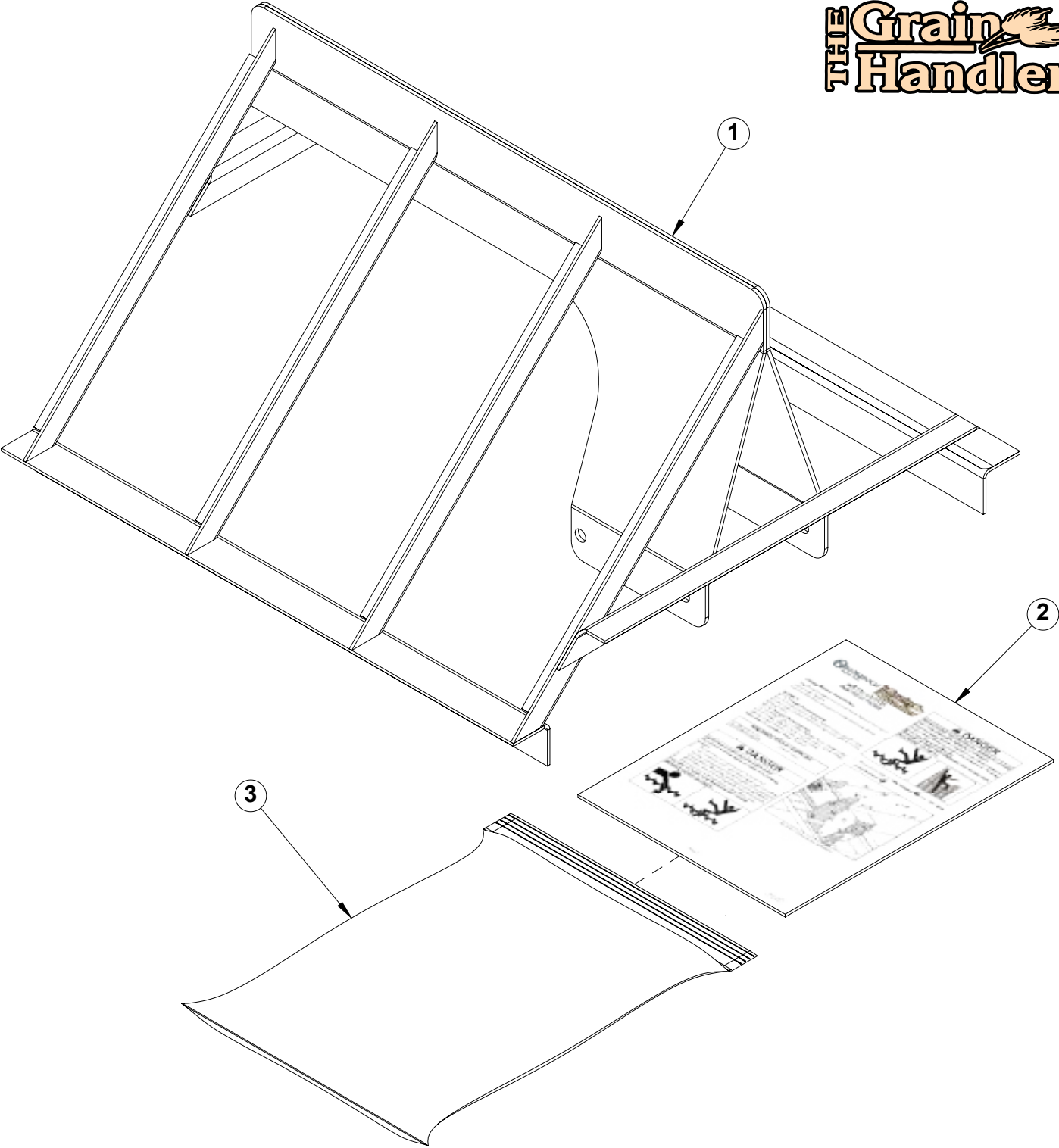

Fig. # 3-3 Clump Buster Installation

PARTS:



10-2-00178 Kit, Clump Buster Assembly			
ITEM	PART NUMBER	DESCRIPTION	QTY.
1	10-3-00064	WELDMENT, CLUMP BUSTER	1
2	10-5-00008	Instructions, Clump Buster Installation	1
3	90-25-2008	Bag, Reclosable 9" x 12" x 2Mil (Clear Plastic) S-1299	1

ADDITIONAL INFORMATION

If you have any questions or need assistance in completing these instructions, please contact your authorized Grain Handler dealer.

Always give your authorized Grain Handler dealer the Model Number of your Grain Handler product when ordering parts, requesting service, or any other information to provide the most efficient service.

The “**Model Number**” for the “**Power Sweep**” & the “**U-Trough**” is identified in the following figure.

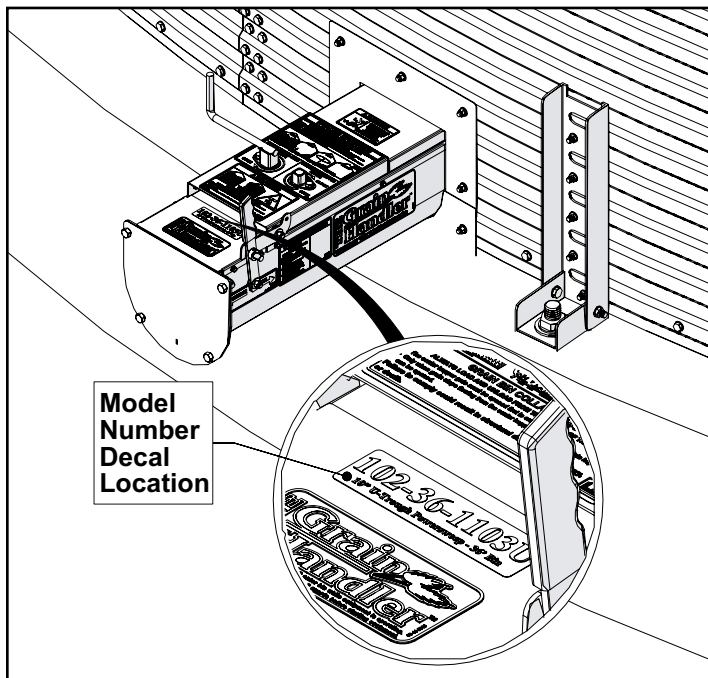

Fig. # 1-4 Locating Model Number Decal (Power Sweep & U-Trough)

Make a copy of the model number below and keep it in a safe place. If the machine is stolen, report the numbers to your local law enforcement agency.

Write the **Model Number, & Date Of Purchase** on the lines provided.

Model Number: _____

Date Of Purchase: _____



Norwood Sales Inc. (Main Office)

• Toll Free: 800-446-0316 • www.norwoodsales.com

Norwood Sales Inc. Cooperstown, ND ☎ 701-797-3684 📠 701-797-3685

Norwood Sales Inc. Horace, ND ☎ 701-588-4000 📠 701-588-4004

Norwood Sales Inc. Union, NE ☎ 402-263-2100 📠 402-263-2104