

## Toolbar Frame Control Quick Reference Guide (ISOBUS)

Rev. B

# YIELDTRAC

The following actions are required for proper operation. This guide is to be used as quick reference only, Please refer to the Yieldtrac Operators Manual for specific information and procedures. **Ensure the area around the toolbar is clear before folding or unfolding the toolbar. Failure to comply could result in death or serious injury.**

Yieldtrac uses common frame control software with the 2150 Case IH planter. Note that the unfold/fold sequence is modified and not all available sequence steps are used. Both the fold and unfold This sequence only applies to Planters loaded with ISOBUS Frame Control.

### Unfolding Toolbar:

0. Start Sequence
1. Lower Wing Wheels
2. Lower Center Section (Cradle Lift)
3. Wing Latch Release (Not Used)
4. Lower Hitch (Not Used)
5. Unfold Wings
6. Lower Hitch (Not Used)
7. Restart Procedure & Lock Hitch Latch\* (Lever Back)

**Note:** The toolbar needs to be raised above the "Unfold Height Frame Calibration" setting in order for the "Lower Center Section" step to work. Ensure the frame is fully raised before lowering the center section. Reference your Case IH documentation for more information on frame height calibration.

**\*Ensure Hitch Latch is Fully Lowered and Secured to Telescoping Hitch before Operating in the Unfolded Position**

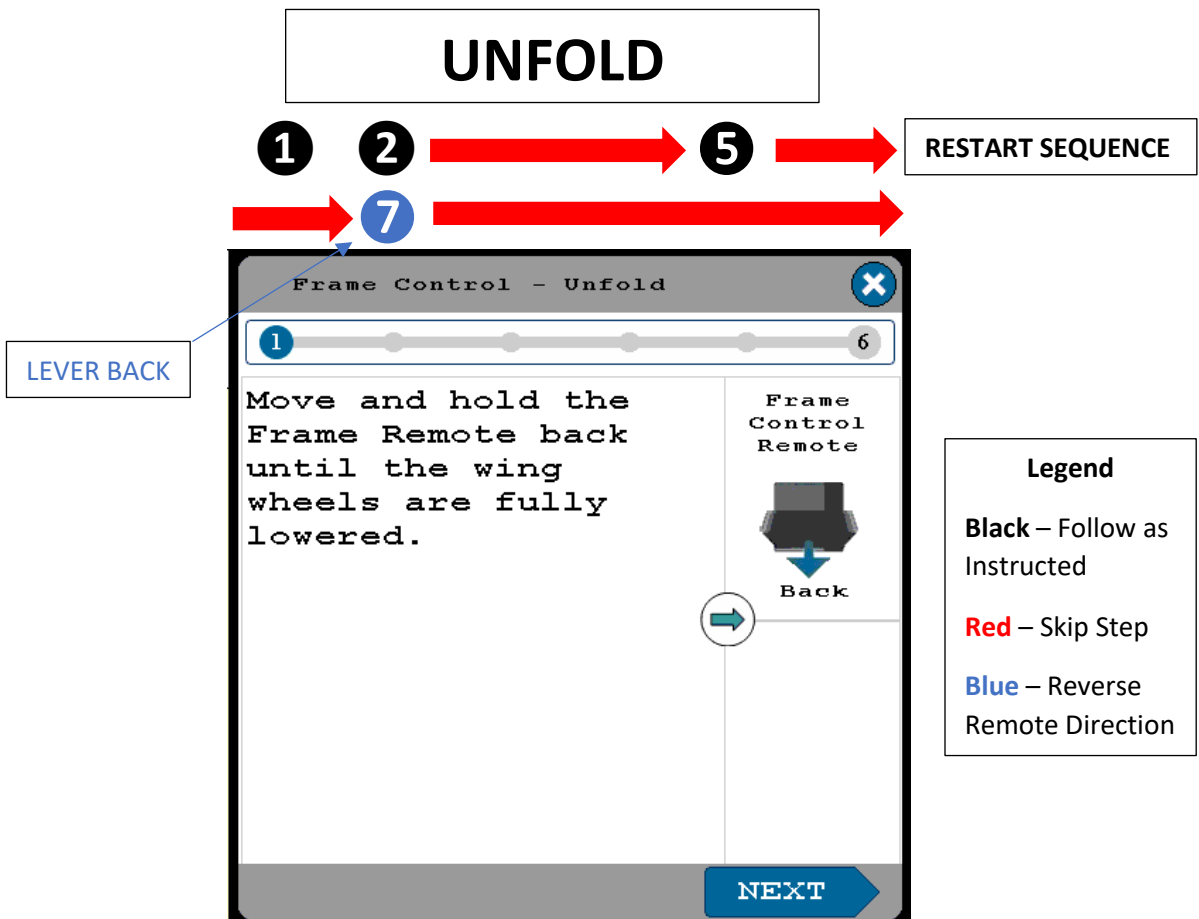

## Toolbar Frame Control Quick Reference Guide (ISOBUS)

Rev. B

# YIELDTRAC

### Folding Toolbar:

0. Start Sequence
1. Fully Raise Planter
2. Raise Hitch (Not Used)
3. Fold Wings (Not Used Yet)
4. Raise Hitch (Not Used)
5. Unlock Hitch Latch  
(Lever Forward)
6. Fold Wings
7. Raise Hitch (Not Used)
8. Raise Center Section (Cradle Lift)
9. Raise Wing Wheels
10. Set Wings (Not Used)

**Note:** Install all transport locks before transporting, consult Yieldtrac Operator's Manual for more information.

## FOLD

LEVER FORWARD

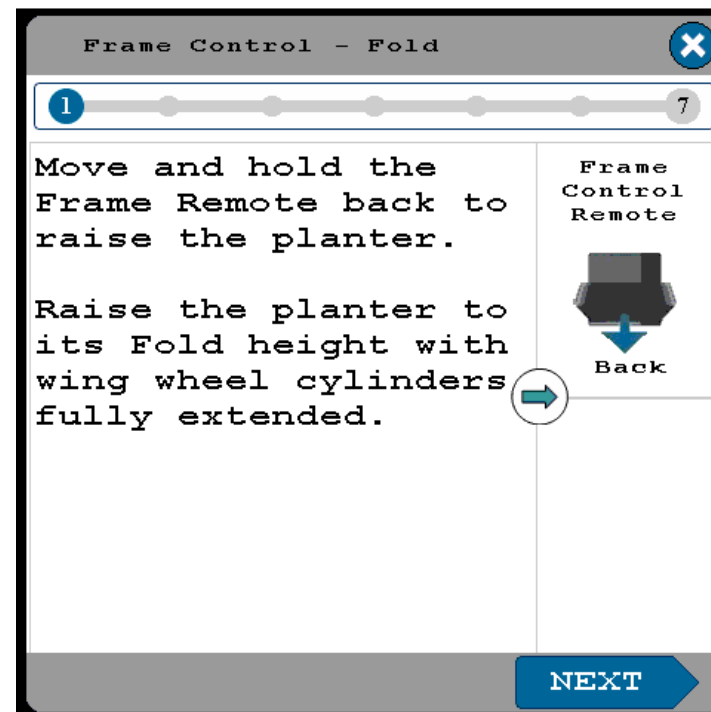
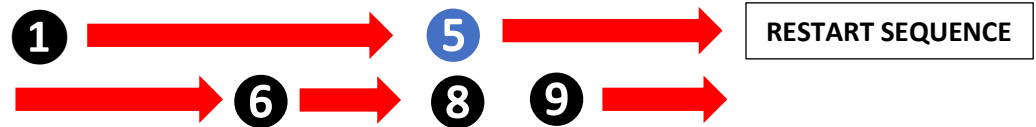

### Legend

**Black** – Follow as Instructed

**Red** – Skip Step

**Blue** – Reverse Remote Direction