



Bunning®

AGRICULTURAL ENGINEERS FOUNDED 1906

North America Manure Spreaders



Made in the USA



A comprehensive range of spreaders for
the application of a wide variety of materials



Bunning Spreaders



www.gtbunning.com

Our Story

After many years travelling from farm to farm as a journeyman blacksmith, it was in 1906 that Robert Bunning finally decided to settle in the village of Gressenhall, ideally situated in the heart of rural Norfolk.

Here at this location he opened the doors of his new smithy tending to the needs of local farmers, as a skilled farrier, renowned within his profession and highly decorated having won many awards and trophies.

It was in 1925 that he was joined by his son George Thomas Bunning whose initials form the business name as it is today. George followed in his fathers footsteps, also becoming an accomplished blacksmith. They continued to service the community for many years, thriving throughout the forties and fifties. As the need for horsepower in farming gradually diminished, the diversification into general agricultural repairs seemed a natural progression for what was to evolve into a strong family concern. During the late fifties, George's son David had joined the business and the first farm trailer was developed and manufactured in 1959.

In 1962 John Bunning joined his father and brother, followed by Robin Bunning in 1969. Expansion was gradual, largely driven by local demand. Regular manufacture of trailers commenced thereafter as farming was becoming increasingly more mechanised. Demand was strong and new product lines were introduced to include a range of slurry tankers, water and fuel bowzers. Rapid expansion was required to fulfil orders. The site had grown to approximately 5 acres with new factory workshops being erected to house an ever increasing workforce. It was in 1987 that John Bunning designed the first Bunning manure spreader which has become the companies' signature product.

"David had bought a small farm next to where he lived," recounts John, "and had begun doing some agricultural contracting work. He'd bought a couple of manure spreaders but they kept breaking down and I said "I'll make you one that will last."

"It was shown to a number of local farmers who all wanted one and mine was sold." "I never did get that spreader," jokes David.

George Bunning had since retired in 1982 leaving Robin, David and John as partners and in 1995 the firm was incorporated as GT Bunning & Sons Ltd.

Over the next two decades Bunnings became one of the most respected manufacturers of agricultural machinery within the UK, establishing a reputation for both quality and service. Innovation and continuous product development secured an enviable presence in both home and export markets. A presence retained to the present day.

A deliberate policy was introduced to specialise purely in the manufacture of manure spreaders, and so from 2010 onwards this was put into effect. Efforts were concentrated on building high performance, high quality spreaders on the market incorporating the latest of technologies. To the present day, machines are manufactured under licence in the USA by Norwood Sales Inc, with Alpha Machinery Limited supplying the established Lowlander brand of rear discharge manure spreaders to North America market. The Company also has a distributor network operating in Australia, South Africa, throughout Europe and the UK.

Now employing members of the fourth generation, the Bunning name remains synonymous with quality and the Company continues to actively seek new opportunities to maintain its outstanding reputation and global market footing.

Robert Bunning's forge still remains as part of the premises today, although not operational.

Robin Bunning

Managing Director

Bunning through the ages



The site as it was in 1965



Robert and George Bunning 1951



The family business 1962



The first Bunning Spreader field trialling in 1987



The 2015 Flagship 380HD HBD Lowlander Widebody developed specifically for the US market



The site as it is in 2015

Lowlander® Twin Vertical Auger Range



Lowlander® Farmstar

- Body width 59"
- Standard Augers
- 2 models
- 141 to 350 ft³
- 6 to 8 ton capacities

Pages 6 to 9



Lowlander® Mk4

- Body width 59"
- Standard Augers
- 5 models
- 240 to 740 ft³
- 7.5 to 15 ton capacities

Pages 10 to 13



Lowlander Widebody®

- Body width 72"
- Standard Augers
- 5 models
- 300 to 1413 ft³
- 14 to 40 ton capacities

Pages 14 to 17

Exclusive to Bunning Spreaders

HEAT TREATED BORON AUGER FLIGHTS, CUTTERS AND PADDLES

Hardness - Boron steel is made harder but not brittle making it more resistant to damage.

Toughness - Boron gives a long service life, reliability and high residual values.

Strength - Boron is twice as strong as mild steel maintaining its form after impact.

Long Life - Boron steel is made harder with a 6.5 times longer life than mild steel.

Lowlander[®] HBD Range



As a dedicated factory build Lowlander spreaders from the 105 Mk4 through to the Widebody 380HD are available with 2 horizontal beaters for processing material onto 2 large diameter spinning discs. Drop on point of material onto the discs and disc blade angles are adjustable for maintaining accurate spread patterns.

Spread widths from 39 to 78 feet are possible dependent on the material's density.



Available in the following builds

Lowlander Mk4 105 HBD
Lowlander Mk4 120 HBD
Lowlander Mk4 150 HBD
Lowlander Widebody 180 HBD
Lowlander Widebody 230 HBD
Lowlander Widebody 320 HBD
Lowlander Widebody 380 HD HBD

* HBD = Horizontal Beaters & Discs

Weigh cells with automatic rate control (option)

The new RDS Apollo spreader controller has all the features for today's farming techniques. Target application rate can be entered into the controller which then monitors the load and adjusts the floor speed accordingly. GPS variable rate technology is supplied as standard and the system can receive an application rate from a third party controller such as a John Deere Greenstar, Raven or Trimble or a pre-defined application map can be loaded to the SD card and automatically vary the rate. Data can be logged and output to Excel or to treatment maps.

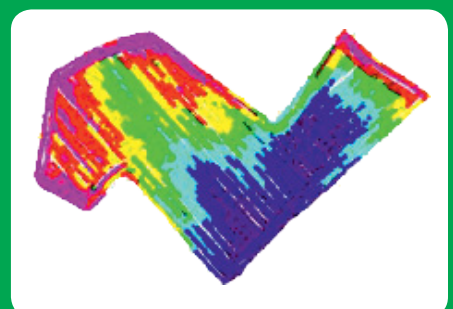
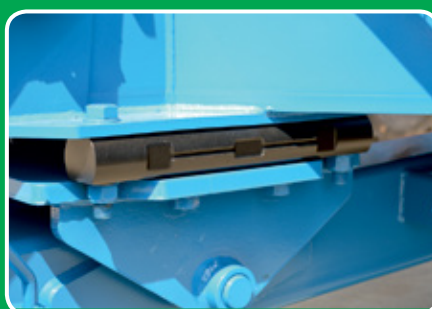

Lowlander® Farmstar® 60 & 80 Spreaders

The Farmstar range is specifically designed for the small scale farmer, while still maintaining all of the features and benefits of the Mk4 range.

Cubic capacities range from 141cu ft for the Farmstar 60 to 350cu ft for the Farmstar 80 with extension sides.

The standard machine is well equipped to spread a variety of materials. A catalogue of optional equipment compliments the basic unit allowing it to be tailored to more specific applications.

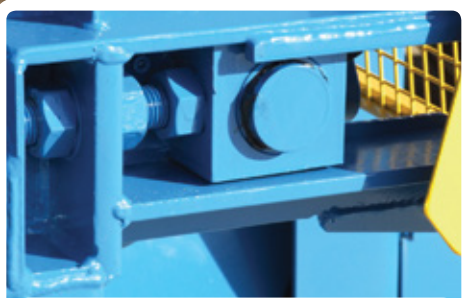

A robust, simple and reliable floor tensioning system ensures floor chain tension can be easily adjusted in order to be kept to its optimum setting. Floor chains are visible from the exterior of the machine making it easy to judge when tensioning is required. Floor shafts are 2" diameter both high tensile.

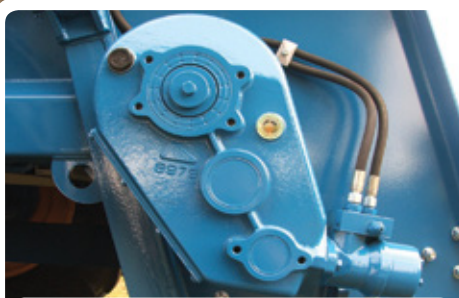

The 350 series floor drive gearbox is fitted to all models.

It is hydraulically driven to ensure an even feed of material to the spreading mechanism at all times. With a reverse feature, any foreign object too large to pass through the beaters can be easily removed. An adjustable crossline relief valve also delivers additional protection.

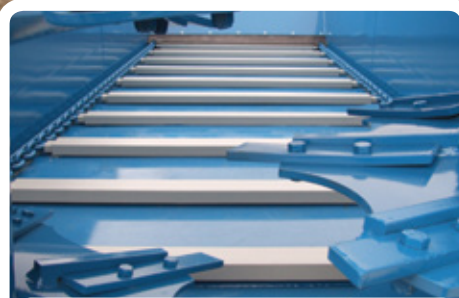

Full width floor slats clear the whole floor eliminating the possibility of bridging - a problem sometimes encountered with multi chain and slat floor systems.

The socket fit design facilitates maintenance, which can be carried out in the field.

It also allows the chain to pull straight, should a slat become bent.



Twin 27" diameter dynamically balanced vertical augers have flights laser cut from heat treated boron steel to improve strength and service life.

Reversible points manufactured using heat treated boron steel are bolted and supported along the back edge.



The robust one piece gearbox houses internal gear sets unique to Bunnings in order to ensure that auger speeds are optimised to achieve excellent spread patterns. They are large in diameter with $2\frac{1}{8}$ " output shafts manufactured from heat treated steel. The precision machined castings ensure perfect alignment of all the driveline components.



Grade 80, 5/8" heavy duty chains are drawn by high tensile sprockets. Sprockets are fitted to the front floor shaft as well as the driven rear shaft, ensuring perfect alignment and timing of the chains, which in turn makes for a more reliable floor drive. Each chain has a 32 ton breaking strain certificate.



2" high tensile floor drive shafts rotate through polyurethane re-inforced composite bushes that contain a solid graphite filler. Chosen for their high load applications in a variety of environments they are greasable, further extending their life.

Bush highlighted in red.

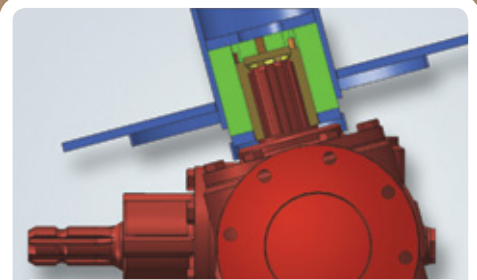

Especially developed to reduce shock loads to the auger drive gearbox, the rubber cushion arrangement located between the output shaft of the auger gearbox and the base of the auger contributes to the reliability and longevity of the machine.

Rubber cushions highlighted in green.

Lowlander® Farmstar® 60 & 80 Spreaders

Standard Specification:

- Heavy duty fully welded construction
- Dynamically balanced twin vertical augers
- Augers protected by rubber cushioned drive
- Auger gearbox protection via shearbolt
- Reversible cutters with re-inforcing plate
- One piece auger gearbox arrangement
- Long lasting composit floor shaft bearings
- Floor protected by cross line relief valve
- High torque hydraulic motor
- Quick fit socket on full width floor slats
- Calibrated grade 80 high tensile floor chains
- Variable floor speed control
- 1000 RPM PTO speed or 540
- Single pole drawbar for tighter turning circle
- Hydraulic brakes & handbrake
- Full road lighting
- Access Ladder

Specifications



FARMSTAR 60 with guillotine slurry door



FARMSTAR 60 with guillotine slurry door, spreading in Japan

	FARMSTAR 60	FARMSTAR 80	FARMSTAR 80 TANDEM
Axle	single	single	tandem
Axle beam size	3.5"	5.0"	3.15"
Carrying capacity	14,546 lbs	17637 lbs	17637 lbs
Cubic feet level	141	212	212
Cubic feet heaped	212	265	265
Cubic feet heaped ext	265	350	350
Body size inches	140 x 59 x 31	177 x 59 x 31	177 x 59 x 31
Floor drive	Hydraulic	Hydraulic	Hydraulic
Floor chain size	5/8"	5/8"	5/8"
Brake size	14" x 3.15"	16" x 4.75"	12" x 3.15"
Tire size	420 x 85 x R34	18.4 x 34 x PR14	13.0/65-18
Spread mechanism	Twin vertical augers	Twin vertical augers	Twin vertical augers
Spread width	up to 52 ft	up to 52 ft	up to 52 ft
PTO speed	540/1000 RPM	540/1000 RPM	540/1000 RPM
Floor plate	3/16"	3/16"	Mar-16
Side plate	3/16"	3/16"	Mar-16
Unladen weight	7,055 lbs	7,700 lbs	8270 lbs

All cubic capacity figures are given without slurry door fitted. Heaped capacity is given assuming a 30 degrees angle to the heap and a 12" radius to the peak.

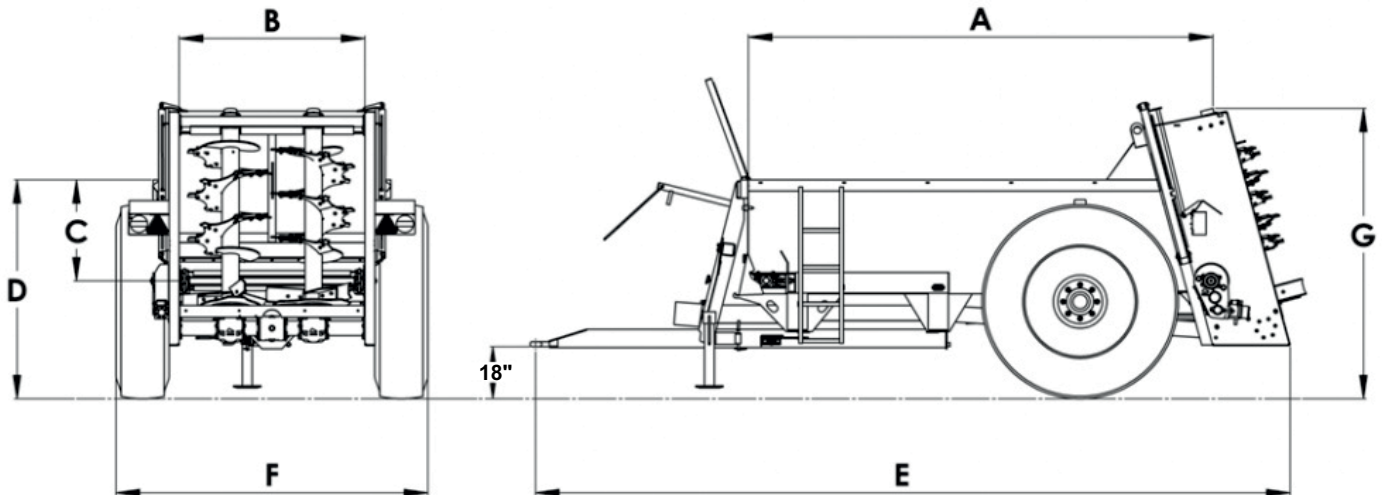

Model	A	B	C	D	E	F	G
Farmstar 60	137.8"	59"	31"	70.3"	240"	99.2"	92.1"
Farmstar 80	186"	59"	31"	73"	277"	105"	97"
Farmstar 80 tandem	186"	59"	31"	71.5"	277"	93.3"	96.8"



FARMSTAR 60 guillotine slurry door, working in Japan



FARMSTAR 80 guillotine slurry door.



FARMSTAR 80 TANDEM with guillotine slurry door.



FARMSTAR 60 with guillotine slurry door.



FARMSTAR 60 with guillotine slurry door and simple canopy spreading chicken litter.

Lowlander[®] Mk4 Manure Spreaders

Originally developed circa 1990, the Lowlander's well proven abilities and features have secured its position at the forefront of today's market. Its popularity has not only been realised within the UK as increasing demand from overseas' markets has led to an established global presence.

The Lowlander Mark 4 Range, so called due to its gradual and incremental evolution, incorporates state of the art technologies as part of a sound overall design to guarantee the user satisfaction in ever competitive environments.

Key qualities of this product are its simplicity, durability and ultimate reliability.

Available in five different models, the smallest boasting a carrying capacity of 240 cubic feet with the largest able to hold up to 740 cubic feet, the Lowlander Mark 4 Range is suitable for farmers and contractors alike. The fully welded body has an internal width of 59" throughout the range.

As a standard machine, the Lowlander Mark 4 is perfectly equipped for general every day usage. Its versatile nature ensures that all manures can be handled very effectively. A catalogue of optional equipment complements the basic unit allowing its use to be tailored to more specific applications, ideal for any contractor. Whatever the associated requirement, the Lowlander Mark 4 can deliver.



A robust, simple and reliable floor tensioning system ensures floor chain tension can be easily adjusted in order to be kept to its optimum setting. Floor chains are visible from the exterior of the machine making it easy to judge when tensioning is required. Floor shafts are 2" diameter (2 $\frac{3}{8}$ " on the 150 model), both high tensile.



The 500 series floor drive gearbox is fitted to all models with the exception of the Lowlander 150 (fitted with 800 series).

It is hydraulically driven to ensure an even feed of material to the spreading mechanism at all times. With a reverse feature, any foreign object too large to pass through the beaters can be easily removed. An adjustable crossline relief valve also delivers additional protection.



Full width floor slats clear the whole floor eliminating the possibility of bridging - a problem sometimes encountered with multi chain and slat floor systems.

The socket fit design facilitates maintenance, which can be carried out in the field.

It also allows the chain to pull straight, should a slat become bent.



Twin 27" diameter dynamically balanced vertical augers have flights laser cut from heat treated boron steel to improve strength and service life.

Reversible points manufactured using heat treated boron steel are bolted and supported along the back edge.



The robust one piece gearbox houses internal gear sets unique to Bunnings in order to ensure that auger speeds are optimised to achieve excellent spread patterns. They are large in diameter with $2\frac{1}{8}$ " output shafts manufactured from heat treated steel. The precision machined castings ensure perfect alignment of all the driveline components.



Grade 80, $\frac{5}{8}$ " heavy duty chains are drawn by high tensile sprockets. Sprockets are fitted to the front floor shaft as well as the driven rear shaft, ensuring perfect alignment and timing of the chains, which in turn makes for a more reliable floor drive. Each chain has a 32 ton breaking strain certificate.



2" high tensile floor drive shafts rotate through polyester re-inforced composite bushes that contain a solid graphite filler. Chosen for their high load applications in a variety of environments they are greasable, further extending their life.

Bush highlighted in red.

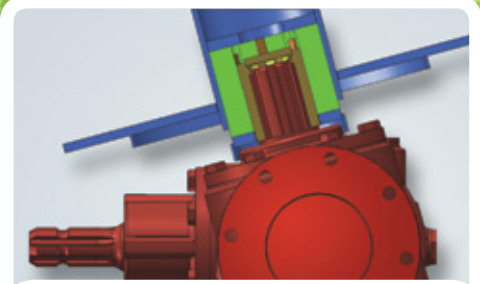

Especially developed to reduce shock loads to the auger drive gearbox, the rubber cushion arrangement located between the output shaft of the auger gearbox and the base of the auger contributes to the reliability and longevity of the machine.

Rubber cushions highlighted in green.

Lowlander® Mk4 Manure Spreaders

Standard Specification:

- Heavy duty fully welded construction
- Handles all manure types and other materials
- Dynamically balanced twin vertical augers
- Augers protected by rubber cushioned drive
- Auger gearbox protection via shearbolt
- Reversible boron cutters with re-inforcing plate
- One piece auger gearbox arrangement
- High tensile front and rear floor shaft
- Long lasting composit floor shaft bearings
- Floor protected by cross line relief valve
- High torque hydraulic motor
- Quick fit socket on full width floor slats
- Calibrated grade 80 high tensile floor chains
- Variable floor speed control
- 1000 rpm PTO speed
- Single pole drawbar for tighter turning circle
- Choice of screwjack or pick up support
- Hydraulic brakes & handbrake
- Full LED road lighting
- Large diameter wheels (options available)
- Automatic light covers (needs slurry door)
- Choice of standard colour 2 pack paint finish
- 3/8" thick auger flights from heat treated boron steel

Specifications

	75 - Mk4	90 - Mk4	105 - Mk4	120 - 12 Tonne	150 - 15 Tonne
Axle	single	single	single	single	single
Axle beam size	5.0"	5.0"	5.0"	5.9"	5.9"
Carrying capacity	18,734 lbs	22,040 lbs	27,770 lbs	30,856 lbs	36,586 lbs
Cubic feet level	240	304	368	410	445
Cubic feet heaped	322	403	467	516	562
Heaped ext. capacity	456	555	618	675	740
Body size (in inches)	169 x 59 x 40	205 x 59 x 39	205 x 59 x 48	216 x 59 x 50	236.2 x 59 x 50
Floor drive	Hydraulic	Hydraulic	Hydraulic	Hydraulic	Hydraulic
Floor chain size	5/8"	5/8"	5/8"	5/8"	5/8"
Brake size inches	14" x 3.2"	15.75" x 3.2"	16" x 4.72"	16" x 4.72"	16" x 5.5"
Tire size	16.9 x 34 PR14	18.4 x 34 PR14	580/70 R38	580/70 R38	580/70 R38
Spread mechanism	Twin vertical augers	Twin vertical augers	Twin vertical augers	Twin vertical augers	Twin vertical augers
Spread width	up to 52 ft	up to 52 ft	up to 52 ft	up to 52 ft	up to 52 ft
PTO speed	1000 RPM	1000 RPM	1000 RPM	1000 RPM	1000 RPM
Floor plate	3/16"	3/16"	3/16"	3/16"	3/16"
Side plate	3/16"	3/16"	3/16"	3/16"	3/16"
Unladen weight	8,640 lbs	9,149 lbs	10,580 lbs	11,240 lbs	13,710 lbs

All cubic capacity figures are given without slurry door fitted. Heaped capacity is given assuming a 30° angle to the heap and a 12" radius to the peak.

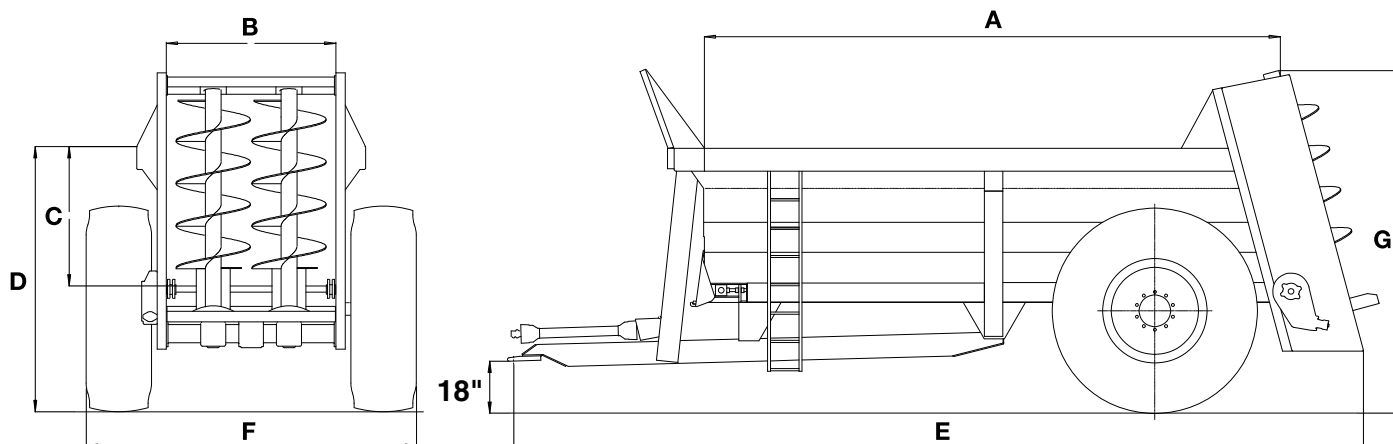

Model	A	B	C	D	E	F	G
75 - Mk4	165.3"	59"	39"	77.5"	256"	103.5"	104"
90 - Mk4	205"	59"	39"	79"	297.6"	105"	105.5"
105 - Mk4	205"	59"	50"	92.5"	297.6"	115"	120.5"
120 - Mk4	216.5"	59"	50"	95"	312"	115"	121.3"
150 - Mk4	236.2"	59"	50"	95.3"	328.7"	115"	121.2"



LOWLANDER 105 standard machine.



LOWLANDER 75 with guillotine slurry door and simple canopy.



LOWLANDER 90 with guillotine slurry door.



LOWLANDER 150 with detachable spinner deck, weigh cells, bolt on extension sides, guillotine slurry door and sprung drawbar.



LOWLANDER 105 with guillotine slurry door, sprung drawbar, weigh cells, built in flared extension and add on spinner deck.



LOWLANDER 120 with guillotine slurry door.



LOWLANDER MK4 with widebody augers.



LOWLANDER 105 with guillotine slurry door.



LOWLANDER 150 with 2 horizontal beaters and spinning discs, weigh cells, built in flared extension sides, guillotine slurry door and sprung drawbar.



LOWLANDER 90 with guillotine slurry door.

Lowlander Widebody[®] Manure Spreaders

With capacities ranging from 300 to 1413 cu ft the Lowlander Widebody range is most suited to large scale farmers & contractors. Available in single, tandem, tri axle or truck mounted builds the Widebody can carry up to 40 tons. With twin 38" diameter shredding augers as standard all types of manure and waste can be spread accurately and evenly up to 65 ft wide.

The fully welded construction ensures long life and unmatched residual values. With an 6 ft internal body width, the proven dual chain full width floor system is used throughout the range, further increasing reliability, performance and strength.

Widebody Spreaders are available in TVA or HBD build.



A robust, simple and reliable floor tensioning system ensures floor chain tension can be easily adjusted in order to be kept to its optimum setting.

Floor chains are visible from the exterior of the machine making it easy to judge when tensioning is required.

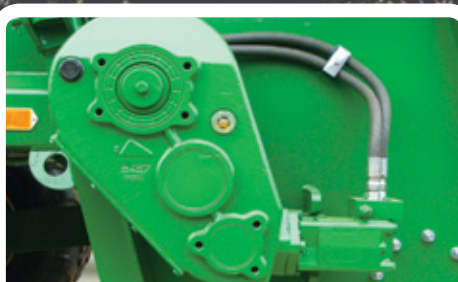

The 800 series floor drive gearbox is fitted to all models within the range. It is hydraulically driven to ensure an even feed of material to the spreading mechanism at all times. With a reverse feature, any foreign object too large to pass through the beaters can be easily removed. An adjustable crossline relief valve also delivers additional protection. The 320 and 380HD models are fitted with 2 floor gearboxes as standard.



Full width floor slats clear the whole floor ensuring materials have no chance of bridging in the middle, a problem sometimes encountered with multi chain and slat floor systems.

The socket fit design enables easy fitting of the slat, it also allows the chain to continue to pull straight should a slat become bent. Heavy duty 3 x 2 x 3/16 box slats are fitted to the Lowlander Widebody 320 and 380HD models.



Twin 38" diameter dynamically balanced vertical augers have flights laser cut from heat treated boron steel to improve strength and service life.

¾" thick reversible points manufactured using heat treated boron steel are bolted and supported along the back edge.



The robust one piece gearbox houses internal gear sets unique to Bunnings in order to ensure that auger speeds are optimised to achieve excellent spread patterns. They are large in diameter with 54mm output shafts manufactured from heat treated steel. The precision machined castings ensure perfect alignment of all the driveline components.



Grade 80, ¾" heavy duty chains are drawn by high tensile sprockets. Sprockets are fitted to the front floor shaft as well as the driven rear shaft, ensuring perfect alignment and timing of the chains, which in turn makes for a more reliable floor drive. Each chain has a 50 ton breaking load certificate.



2³/₈" high tensile floor drive shafts rotate through polyester re-inforced composite bushes that contain a solid graphite filler. Chosen for their high load applications in a variety of environments they are greasable, further extending their life.

Bush highlighted in red.

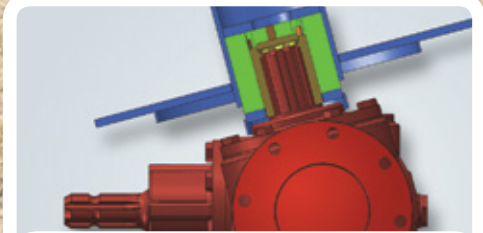

Especially developed to reduce shock loads to the auger drive gearbox, the rubber cushion arrangement located between the output shaft of the auger gearbox and the base of the auger contributes to the reliability and longevity of the machine. Rubber cushion high lighted in green.

Lowlander Widebody® Manure Spreaders

Standard Specification:

- Heavy duty fully welded construction
- Handles all manure types and other materials
- Widebody (38" dia.) dynamically balanced twin vertical augers
- 6 ft internal body width
- Augers protected by rubber cushioned drive
- Auger gearbox protection via shearbolt and over run clutch
- 3/8" thick auger flights from heat treated boron steel
- Reversible cutters with re-inforcing plate 3/16" thick
- One piece auger gearbox arrangement
- High tensile 2³/₈" front and rear floor shaft
- Long lasting composite floor shaft bearings
- Floor protected by cross line relief valve
- High torque hydraulic motor
- Quick fit socket on full width floor slats
- Calibrated 3/4" grade 80 high tensile floor chains
- Variable floor speed control
- 1000 RPM PTO speed
- Single pole drawbar for tighter turning circle
- Choice of screwjack or pick up support
- Hydraulic brakes & handbrake
- Full LED road lighting
- Access Ladder
- Choice of standard colour 2 pack paint finish
- Automated light covers (needs slurry door)

Specifications

	140 Truck Mnt	180	230	320	380HD
Axle	N/A	single		Tri-axle	Tri-axle
Axle beam size	N/A	6.0"	5.0"	6.0"	6.0"
Carrying capacity	30,865 lbs	39,680 lbs	50,700 lbs	70,550 lbs	88,185 lbs
Cubic feet level	300	353	353	583	583
Cubic feet heaped	460	495	495	777	777
Heaped ext. capacity	N/A	918	918	1236	1413
Body size (in inches)	197 x 72 x 37	236 x 72 x 37	236 x 72 x 37	315 x 72 x 45.5	315 x 72 x 66.5
Floor drive	Hydraulic	Hydraulic	Hydraulic	Hydraulic	Hydraulic
Floor speed control	Hydraulic variable speed c/w reverse				
Floor chain size	3/4"	3/4"	3/4"	3/4"	3/4"
Brake size inches	N/A	16" x 5.5"	15.7 x 3.1"	15.7 x 4.7"	16" x 5.5"
Tire size	N/A	580/70 R38	600/55 R22.5	600/55 R22.5	600 /55 R26.5
Spread mechanism	Twin vertical augers	Twin vertical augers	Twin vertical augers	Twin vertical augers	Twin vertical augers
Spread width	up to 66 ft	up to 66 ft	up to 66 ft	up to 66 ft	up to 66 ft
PTO speed	1000 RPM	1000 RPM	1000 RPM	1000 RPM	1000 RPM
Floor plate	3/16"	3/16"	3/16"	3/16"	3/16"
Side plate	3/16"	3/16"	3/16"	3/16"	3/16"
Unladen weight	8,820 lbs	15,500 lbs	17,460 lbs	24,250 lbs	31,000 lbs

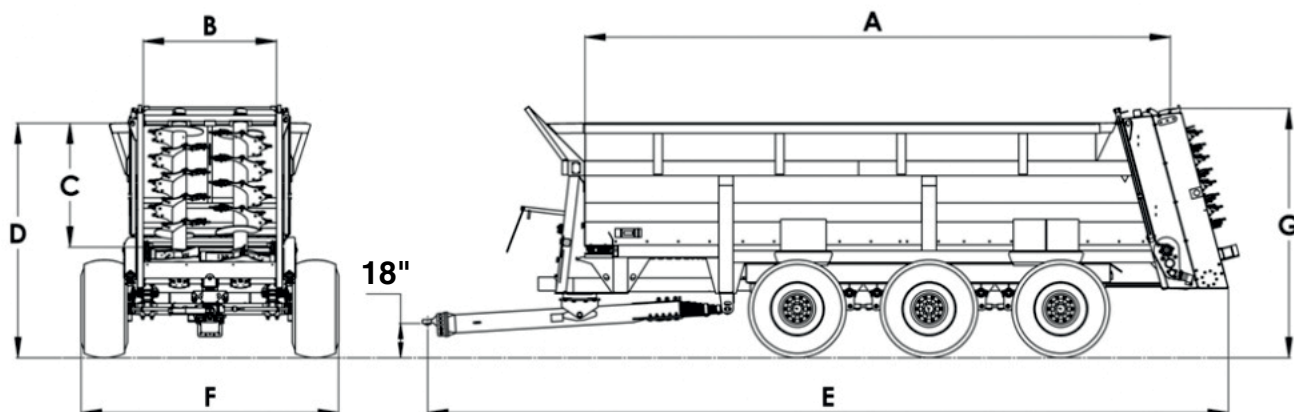

Model	A	B	C	D	E	F	G
140 Truck Mnt	197"	72"	37.8"	N/A	252"	N/A	N/A
180	236.2"	72"	37.8"	84.6"	337"	128.5"	121.2"
230	236.2"	72"	37.8"	84.6"	337"	132"	121.2"
320	315"	72"	59"	99"	433"	139.5"	126.8"
380 HD	315"	72"	66.5"	126"	433"	139.5"	135"



LOWLANDER WIDEBODY 380HD HBD working in Iowa USA.



LOWLANDER 140 WIDEBODY TRUCK MOUNT with guillotine slurry door.



LOWLANDER WIDEBODY 230 HBD with built in flared extension sides, guillotine slurry door, sprung drawbar, weigh cells and 600/55 R26.5 tires.



LOWLANDER WIDEBODY 380HD HBD with guillotine slurry door, border deflector and 650/65 R30.5 Michelin tires, weigh cells and auto rate control.



LOWLANDER 230 WIDEBODY sludge cake build with built in flared extension sides, wheels under body, and guillotine slurry door.



LOWLANDER 380HD with bolt on extension sides, guillotine slurry door, sprung drawbar and weigh cells.



Optional hydraulic suspension and steering axle.



LOWLANDER 230 WIDEBODY with built in extension sides, guillotine slurry door, sprung drawbar and weigh cells.



LOWLANDER 180 WIDEBODY HBD with 2 horizontal beaters and spinning discs, weigh cells, bolt on flared extension sides and 710/70 R38 tires.



LOWLANDER 230 with built in flared sides, guillotine slurry door, sprung drawbar and weigh cells

Optional Equipment



Widebody Augers

- Farmstar 60 - 80 ○
- Mk4 75 - 90 ○
- Mk4 105 - 150 ●
- Widebody STD



2 Horizontal Beaters & Spinning Discs

- Farmstar 60 - 80 ○
- Mk4 75 - 90 ○
- Mk4 105 - 150 ●
- Widebody ●



Detachable Spinner Deck

- Farmstar 60 - 80 ○
- Mk4 75 - 90 ○
- Mk4 105 - 150 ●
- Widebody ●



High Augers

- Farmstar 60 - 80 ○
- Mk4 75 - 90 ●
- Mk4 105 - 150 STD
- Widebody STD



Sprung Drawbar

- Farmstar 60 - 80 ○
- Mk4 75 - 90 ●
- Mk4 105 - 150 ●
- Widebody ●



Steel PTO Guard

- Farmstar 60 - 80 ●
- Mk4 75 - 90 ●
- Mk4 105 - 150 ●
- Widebody ●



Load Cells

- Farmstar 60 - 80 ●
- Mk4 75 - 90 ●
- Mk4 105 - 150 ●
- Widebody ●



Electric Remote Floor Control

- Farmstar 60 - 80 ●
- Mk4 75 - 90 ●
- Mk4 105 - 150 ●
- Widebody ●



Drop Down Covers

- Farmstar 60 - 80 ●
- Mk4 75 - 90 ●
- Mk4 105 - 150 ●
- Widebody ●



Simple Canopy

- Farmstar 60 - 80 ●
- Mk4 75 - 90 ●
- Mk4 105 - 150 ●
- Widebody ●



Swivel Pick-up Eye Attachment

- Farmstar 60 - 80 ●
- Mk4 75 - 90 ●
- Mk4 105 - 150 ●
- Widebody ●



Bolt on Extension Sides

- Farmstar 60 - 80 ●
- Mk4 75 - 90 ●
- Mk4 105 - 150 ●
- Widebody ●



Tool Box

- Farmstar 60 - 80 ●
- Mk4 75 - 90 ●
- Mk4 105 - 150 ●
- Widebody ●



Guillotine Slurry Door

- Farmstar 60 - 80 ●
- Mk4 75 - 90 ●
- Mk4 105 - 150 ●
- Widebody ●



Built-in Flared Extension Sides

- Farmstar 60 - 80 ○
- Mk4 75 - 90 ●
- Mk4 105 - 150 ●
- Widebody ●



Rear Clevis Drawbar Assembly

- Farmstar 60 - 80 ●
- Mk4 75 - 90 ●
- Mk4 105 - 150 ●
- Widebody ●

Optional Equipment continued...

	Farmstar 60 - 80	Mk4 75 - 90	Mk4 105 - 150	Widebody
Sludge Cake Kit	●	●	●	●
Lift off Augers	●	●	●	●
Silage Sides	●	●	●	●
10 Stud Axle (excluding Lowlander Mk4 75)	●	STD	STD	STD
Wide Angle PTO	●	●	●	●
Wide Angle PTO with Torque Limiter	●	●	●	●
Steering Axle	○	○	○	230 320 & 380
2 Line Air Brakes	●	●	●	●
Dual Air & Hydraulic Brakes	●	●	●	●
Non Standard Colour Finish Paint	●	●	●	●

Suspension for tandem axle machines can be rocking beam, leaf sprung or hydraulic. For tri-axle machines leaf sprung or hydraulic suspension is available.

Wheel Options

18.4x34	STD 80 ONLY	75 ONLY	○	○
18.4x38	80 ONLY	○	○	○
480/70 R34	60 ONLY	●	○	○
520/780 R34	●	●	○	○
580/70 R38	80 ONLY	●	STD	○
580/70 R38 High Load	80 ONLY	●	●	○
620/70 R38	●	●	●	○
650/65 R38	80 ONLY	●	●	180 ONLY
710/70 R38	●	●	●	STD 180 ONLY
550/45 R22.5	80 ONLY	○	○	○
600/55 R22.5 380 Tread Pattern	○	○	○	230 / 320



With our continual development programme we use a state of the art 3D CAD system, which we have recently added a Stress Analysis (FEA) package to.

This enables us to highlight any potential problems such as fatigue long before they may occur in the field, therefore assisting us in the design of the next generation of spreaders. This, in conjunction with customer feedback, keeps Bunning at the forefront of design and development.



Machines built in the USA.

All machines are sand blasted prior to painting, then powder coat painted and left to oven cure. The automated line includes a 7 stage washer, Nordson powder paint booth and an overhead oven for a high quality finish.

Bunning®

AGRICULTURAL ENGINEERS

North America



address Smithy House
The Green
Gressenhall
Dereham
Norfolk
NR20 4DT

telephone +44 (0) 1362 860352
facsimile +44 (0) 1362 860930
email sales@gtbunning.co.uk
website www.gtbunning.com

dealer